

14. Timing Belt Cover

A: REMOVAL

NOTE:

When replacing a single part, perform the work with the engine assembly installed to body.

- 1) Remove the secondary air pump. <Ref. to EC(STI)-53, REMOVAL, Secondary Air Pump.>
- 2) Remove the crank pulley. <Ref. to ME(STI)-48, REMOVAL, Crank Pulley.>
- 3) Remove the timing belt cover RH (B) together with the engine harness cover (A).
- 4) Remove the timing belt cover LH (D) together with the engine harness stay (C).
- 5) Remove front timing belt cover (E).

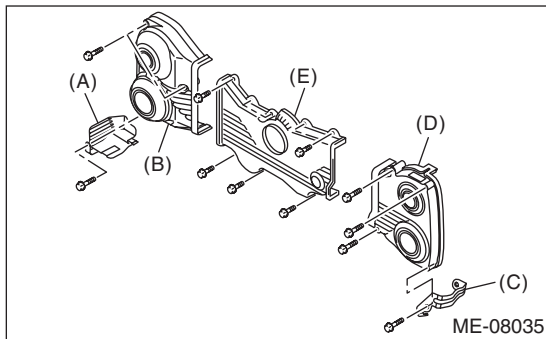

B: INSTALLATION

- 1) Install front timing belt cover (E).

Tightening torque:

5 N·m (0.5 kgf-m, 3.7 ft-lb)

- 2) Install the timing belt cover LH (D) together with the engine harness stay (C).

Tightening torque:

5 N·m (0.5 kgf-m, 3.7 ft-lb)

- 3) Install the timing belt cover RH (B) together with the engine harness cover (A).

Tightening torque:

5 N·m (0.5 kgf-m, 3.7 ft-lb)

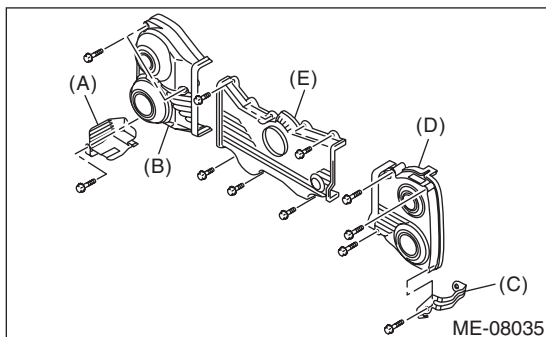

- 4) Install the crank pulley. <Ref. to ME(STI)-48, INSTALLATION, Crank Pulley.>
- 5) Install the secondary air pump. <Ref. to EC(STI)-53, INSTALLATION, Secondary Air Pump.>

C: INSPECTION

Check the timing belt cover for damage.